



Yuasa Fiche de données techniques

Yuasa YB14L-A - YuMicron Batterie

Performance

Tension	12V
Capacité (10heures)	14Ah
Capacité (20 heures)	14.7Ah
CCA à -18°C	190A

Dimensions (±2mm)

Longueur	134mm
Largeur	89mm
Hauteur	166mm

Poids & Mesures

Poids moyen avec acide	4.6kg
Volume d'acide	0.9l



Technologie

Technologie	Moulé Sb/Sb
Séparateur	Leaf

Schéma de montage des éléments

Type de bornes - 6

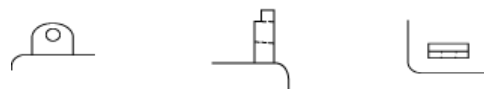
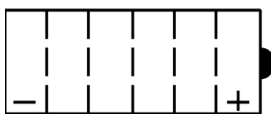

Date de publication: 10/03/2020 - E&OE



Yuasa Technical Data Sheet

Yuasa YB14L-A - YuMicron Battery

Performance

Voltage	12V
Capacity (10-hour)	14Ah
Capacity (20-hour)	14.7Ah
CCA @ -18°C	190A

Dimensions (±2mm)

Length	134mm
Width	89mm
Height	166mm

Weights & Measures

Mean Weight with Acid	4.6kg
Acid Volume	0.9l



Technology

Technology	Cast Sb/Sb
Separator	Leaf

Cell Assembly Layout

Terminal Type - 6

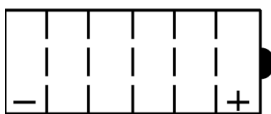

Data Sheet generated on 10/03/2020 - E&OE