

Bike	Lambretta V125 Special	Part No.	RLA-50
Year	2021-Current	Fit Kit	Z039.10711
Notes	Where not supplied use original fittings	dB Killer	SCEXDBK23 - (Type V)

Estimated Fitting Time: 60 Minutes

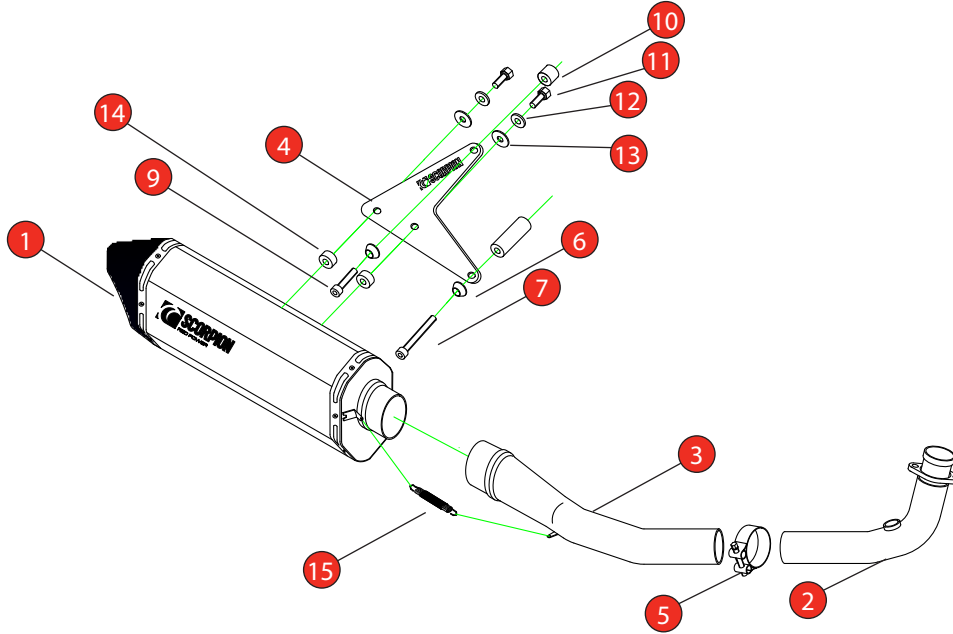

NO.	PART NO.	DESCRIPTION	QTY
1	RSC511	Serket Silencer	1
2	Z035.11159	Header Pipe	1
3	Z035.11160	Connecting Pipe	1
Fit Kit - Z039.10711			
4	Z007.31706	Silencer Bracket	1
5	Z016.10010	34-37mm Clamp	1
6	Z026.20068B	Black Bolt Finisher	2
7	Z017.10087	M8 x 110mm Caphead Bolt	1
8	Z026.10019	80mm Alloy Spacer	1
9	Z017.10081	M8 x 65mm Caphead Bolt	1
10	Z026.10009	35mm Alloy Spacer	1
11	Z017.10049	M8 x 30mm Hex Bolt	2
12	Z017.10064	M8 Spring Washer	2
13	Z017.10831	M8 Washer	2
14	Z026.20049	5mm Alloy Spacer	2
15	Z028.10030	Spring	1

CLASSIFICATION	Closed Circuit Product
HOMOLOGATED	No
DATE	18/11/2022
ISSUE	01
AUTHORISED	S Shipley

NOTE: ENSURE SCORPION SYSTEM IS CLEAR OF MOVING PARTS AND ALL ORIGINAL FUNCTIONS WORK CORRECTLY.



STAY CONNECTED TO RED POWER.

Bike	Lambretta V125 Special	Part No.	RLA-50
Year	2021-Current	Fit Kit	Z039.10711
Notes	Where not supplied use original fittings	dB Killer	SCEXDBK23 - (Type V)



A) Start by removing the Lambda sensor from the header pipe.

B) Next remove the 2 header nuts.

C) The OE silencer has 2 mounting points. Undo the lower bolt first.

D) Then whilst supporting the weight of the system undo the upper mounting bolt.

E) You can now lower the system and carefully remove from the bike.

F) The OE system uses a gasket on the header pipe. This is not required for the Scorpion system. If it stays in the header port you will need to remove it before continuing.

G) Fit the Scorpion header pipe to the bike using the original header nuts. At this stage you should leave them slightly loose to allow adjustment.

H) Slide the connecting pipe along with the clamp onto the header pipe.

Bike	Lambretta V125 Special	Part No.	RLA-50
Year	2021-Current	Fit Kit	Z039.10711
Notes	Where not supplied use original fittings	dB Killer	SCEXDBK23 - (Type V)



I) Place the silencer face down on a cloth to avoid damaging it and then install the silencer bracket with the supplied hardware following the line diagram on the 1st page. Fully tighten the mounting bolts.

J) Slide the silencer onto the connecting pipe. Make sure you have the mounting hardware to hand as you will need to support the weight of the silencer once it's on the connecting pipe.



K) Attach the silencer to the bike using the supplied hardware and spacers. The smaller spacer is used for the top mounting point, start with this one. Do not fully tighten yet.

L) Use the longer spacer and bolt for the lower mounting point. Again do not fully tighten at this stage.



M) Install the spring between the silencer and connecting pipe.

N) Adjust the system so that it sits nicely, is clear of moving parts and is under no stress. Then starting with the header nuts, then the clamp and finally the 2 silencer mounting bolts fully tighten everything.

O) Before reinstalling the Lambda sensor twist it anti clockwise a few times so that when it's screwed into the header pipe you are not left with a twisted cable.



P) Install the lambda sensor and fully tighten.

Take the bike for a short ride to ensure it functions as it should. Once the bike and exhaust are cool enough check all nuts and bolts are still secure.

Bike	Lambretta V125 Special	Part No.	RLA-50
Year	2021-Current	Fit Kit	Z039.10711
Notes	Where not supplied use original fittings	dB Killer	SCEXDBK23 - (Type V)

Estimated Fitting Time: 60 Minutes



Thank you for purchasing your Scorpion Silencer.

Care of your exhaust: Please refrain from cleaning silencer with heavy solvents or abrasives!

Vielen Dank Für den kauf eines Scorpion Schalldampfers! Pflegehinweis: Bitte verwenden Sie niemals Scheuermittel oder aggressive Reiniger zur Pflege Ihres Auspuffes!

Merci d'avoir choisi un echappement Scorpion.

Entretien de votre silencieux: Ne pas utiliser de solvants ou de produits abrasifs!

Muchas gracias por adquirir un Silencioso Scorpion. Le recomendamos no limpiar el silencioso con productos abrasivos o aquellos que contengan disolventes.



STAY CONNECTED TO RED POWER.